

ISID | STAIR IDENTIFICATION SIGN

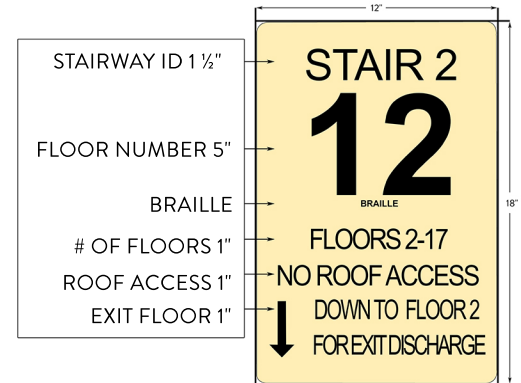
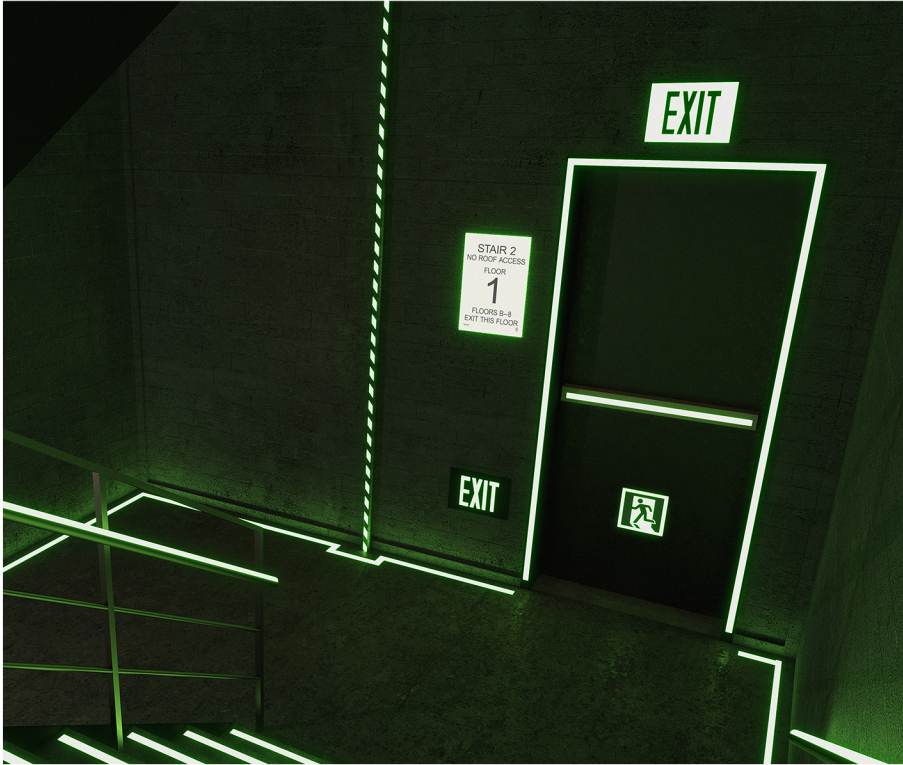

Photoluminescent Stairway Identification Signs meet building code egress requirements. Stairway identification signs that are customized to meet your project's specific needs.

- Required for every floor
- 12" x 18" photoluminescent background
- Identification of stair - Minimum 1 1/2" in height
- Floor number - Raised and a minimum of 5" in height
- Braille to comply with ICC A117.1

Code Compliant in all 50 states and Canada:

Exceeds ASTM E2072 glow requirements
Code compliant: ICC/IBC/IFC/ASTM E2072/NFPA 101/OSHA/ADA

UL 1994 listed



5-Year Warranty

Safe-T-Nose®

LEAVE NO DOUBT • THIS WAY OUT • EXIT SAFELY



IBC/IFC 1023.9 Stairway identification signs shall be provided at each floor landing in an interior stair connecting more than three stories. If a high rise, in most occupancies Stair Identification Signs must be photoluminescent.